

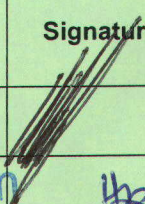

DESTINATION ROTORUA ROTORUA DISTRICT COUNCIL	1 Processing PIM / TAR / BC / Amendment Master Checklist	Ref: CP 06
		Ver: 15
		Issued: 27 Apr 2011
		IT-641173
		Page 1 of 6

CATEGORY	NZSFC	CONTRACTOR	INSPECTOR	INSPECTOR
NAI		BC ONLY	Jan	Berry
PIM/BC Application No.		# 67914	Valuation No. 06512-625-00	
Owner: VINCENT		Property File No. 02494		
Project Location: 11 SOPHIA STREET				
Description of Work: VICENT LOUERE MAX SFH				
PIM Issued:		BC Issued: 29/6/11		

PIM Tracking Record:

Hazard/Caution/ Information (as noted on file)	na SFH only				
Processing	Referral Date (Building Services)	Name	Signature	Date Reviewed	Early Notification or PIM suspension
Building Services	28/6/11	A Hoffman		28/6/11	Y (N)
Admin Assistant - Building	28/6/11	H Ferguson		29/6/11	Y N
Planning					Y N
Resource Engineer					Y N
Pollution Control					Y N
Development Contributions					Y N
Regulatory/Geothermal					Y N
Environmental Health					Y N
Recreation & Community					Y N

BC Tracking Record

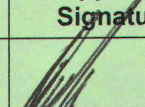
	Date Reviewed	Name	Suspend Consent	Approval Signature	Date of Approval
Building Consent		A Hoffman	Y N		28/6/11

Records sent to applicant and TA. Administration to complete on issue (✓ included or x NA)	Plans	✓	Supporting documentation	✓	Section 37 Notice	
	PIM	x	Building Consent	✓	Section 36 Notice	
Name: H Ferguson	Signature:		Date:	29/6/11		



RRD001PSWG

Document Number: RDC-201391

Date Registered: 12/07/2011

Document Set ID: 2337373

Version: 1, Version Date: 12/07/2011

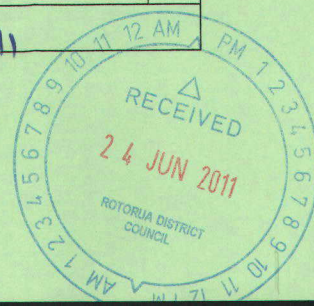

PIM ENDORSEMENTS

300	a	b	c	d	e	g	h	i	j	k	l	f
302	a	b	c	d	e	g	h	i	j	k	l	m
	n	o	p	q	r	s	t	u	v	w1	w2	w3
	x	y	z	f								
304	a	b	c	f								
306	a	b	c	d	e	g	h	i	j	k	l	m
	n	o	f									
308	a	b	c	d	e	f						
312	a	b	c	d	e	g	h	i	j	k	l	m
	n	o	p	q	f							
314	a	b	c	d	e	g	h	i	j	k	l	m
	f											
316	a	b	c	d	e	g	h	i	j	k	f	
318	a	b	c	d	e	g	h	i	j	k	f	
320	a	b	c	d	e	g	h	i	j	f		
322	a	b	f									
324	a	b	c	d	e	g	h	i	j	k	f	
330	a	b	c	d	f							
336	a	b	f									
338	a	b	c	d	e	g	f					
340	a	b	c	f								
342	a	b	c	f								
344	a	b	c	d	e	g	h	i	j	k	l	
	m	n	o	p	q	r	s	t	u	f		
346	a	f										
348	a	b	c	d	e	g	h	i	j	k	l	
	m	n	o	p	q	r	s	t	u	v	w	
	x	y	z	f								
350	a	b	c	d	e	g	f					
352	a	b	c	f								
354	a	b	c	f								
356	a	b	c	d	e	g	h	f				
358	a	b	c	d	f							
360	a	b	c	d	f							
362	a	f										
364	a	f										
366	a	b	c	d	f							
368	a	b	f									
370	a	b	c	f								
372	a	b	f									
374	a	b	f									
376	a	b	c	f								

BUILDING SECTION Please record any thing that may be relevant to the processing Building Officer

PLANNING SECTION (Section 37 Notice) Please record considerations and reasons for decisions

Zone

Any notified plan changes / proposed Designations relevant? (check RDC web site)

Y N

Any relevant Planning Land Features that may impact on whether planning consent require.

Y N

Check all Planning PIM standard statements-(Circle any relevant) *special zoning provisions SP / Scheduled site / Building on uncompleted subdivision / Development / Road widening / Appendix A sites / Service lanes / Special Height controls (airport, Maori Villages) / Airport noise / height issues / reserve contribution required for permitted activity / Hazardous substances / Contamination etc*

Proposal may affect Marae (can be on an adjacent site) (Liaise with Director Kaupapa Maori)

Outcome.....

The proposal requires resource consent or other planning consent (early notification if yes)

Y N

No resource consent or other planning consent is required for the proposal

- The proposal is a permitted activity and enough info is provided to demonstrate all relevant performance standards are met, site plan sighted, height and daylighting planes checked, all required parking and turning, reserve contribution needs to be picked up for permitted activities etc
- Existing use rights apply (why).....
- Proposal in accordance with designation.....
- Other reason.....

The proposal requires resource consent under Rule / s.....3..... of the Operative District Plan (*note the rules and reasons why consent required*)

Resource consent has been applied for on..... The consent number is.....

The planner processing the application is

The proposal is in accordance with Resource Consent numbered RC..... Which was granted on

Please ensure you are familiar with any consent conditions and ensure all are complied with.

The proposal is not in accordance with Resource Consent numbered RC..... Provide details of conditions not met and info required. (**early notification**)

Y

N

The proposal requires outline plan approval as the site is designated for the purpose of

There is insufficient information with the application to determine whether resource consent is required or otherwise. The following information is required. (**early notification**)

The proposal may affect an historic place (*let Building know ASAP for section 39 notification*) The site is listed in Appendix A of the District Plan. Number..... The site is registered NZHPT, site.....

Y

N

Free Text

Further Information Reviewed (*record what was supplied, how compliance demonstrated and outcome*)

Name

Signature

Date

RESOURCE ENGINEER Please record considerations and reasons for decisions

4

Further Information Reviewed (*record what was supplied, how compliance demonstrated and outcome*)

Name

Signature

Date

ENGINEERING POLLUTION CONTROL Please record considerations and reasons for decisions

Circle

Grease trap required

Y

N

Further Information Reviewed (*record what was supplied, how compliance demonstrated and outcome*)

Name

Signature

Date

ENGINEERING (Development Contribution Notice) Please record considerations and reasons for decisions

Circle

Development contribution applies (**early notification**)

Y

N

Copy of Development contribution notice attached (**early notification**)

Y

N

GEO THERMAL Please record considerations and reasons for decisions

Site Inspection Calculation / Condition Sheet

5

PROCESSING	TIME ALLOCATED	TIME TAKEN (Quantity)	TOTALS in Dollars
Processing Hrs INSPECTOR			
Processing Fees Paid			
SUB TOTAL			
Further information			
TOTAL PROCESSING COST			
400 INSPECTIONS (Circle correct letter)	GUIDE ONLY – DEPENDENT ON COMPLEXITY & SIZE OF PROJECT.	No of Inspections	No of ¼ HR Increments
a. Siting, Footings, Foundations	3	0.75	
a. Retaining Walls	2/3	0.5 – 0.75	
b. Subfloor Bracing & Fixing	2	0.5	
c. Pre-floor P&D	2	0.5	
d. Concrete Floor Building	2	0.5	
e. Pre-Wrap <200-<300->etc	3	0.75–1.0–1.25	
g. Wrap Only	2	0.5	
g. Wrap/Cavity Battens	3	0.75	
h. ½ High Brick	2	0.5	
i. Bond Beams (One Block- full basement)	2	0.5 – 0.75	
j. Precast Concrete Work	2	0.5	
k. Pre Plaster	3	0.75	
l. Solar water heater	2	0.50	
m. Preline Building	3	0.75	
n. Preline P&D	2	0.5	
o. Wet Areas/Tanking/Basements	2	0.5	
p. Postline (Addition - New Dwelling)	2	0.5 – 0.75	
q. Sanitary & Stormwater Drainage (Alteration / New Conn - New Dwelling)	2	0.5 – 0.75	
r. Enclosed Decks – membrane roofs/gutters	2	0.5	
s. Disconnection drainage	2	0.5	
t. Swimming Pools (Pool fencing)	2	0.5	
u.a. Solid Fuel Heater	2	0.5	
u.b. In Built Solid Fuel Heater			
v. Final Inspection (add time for paper work for minor consents ¼ hr)	4/5	1.0-1.25	
w Combined inspections	Complete free text on sheet 5		
x Trade waste			NC
f Free text	Complete free text on sheet 5		
Building officer desk top review (allow 5 min each allocated inspection, dwellings/ commercial only)			
CCC Assessment (not required for garages, carports and minor works)			
Other			
TOTAL NUMBER OF INSPECTIONS			
Plus Travel			
TOTAL INSPECTION COST			

ENVIRONMENTAL HEALTH Please record considerations and reasons for decisions

Officers will contact the applicant to complete Health application and information booklet

Y

N

RECREATION AND COMMUNITY Please record considerations and reasons for decisions

The applicant requires the approval of the Parks and Recreational Manager to carry out works proposed in the vicinity of Council vegetation.

Y

N

The applicant requires the approval of the Parks and Recreational Manager to shift / replace Council vegetation that will be effected by the proposal. The applicant shall pay / carry out compensation / remedial work as instructed

Y

N

Building Consent Processing Section:**Building Consent Endorsements:****Conditions:-****Inspections:**

400 see over page

Additional Building Act Conditions

401 a b c d

f

Important Endorsements

402	a	b	c	d	e	g	h	i	j
	k	l	m	n	o	oa	ob	p	q
	r	s	t	u	v	w	x	y	f

Compliance Schedule SS and CS systems

403	a	b	c	d	f					
	ss1	ss2	ss3/1	ss3/2	ss3/3	ss4	ss5	ss6	ss7	ss8/1
ss8/2	ss8/3	ss9/1	ss9/2	ss10	ss11	ss12	ss13/1	ss13/2	ss13/3	ss14/1
ss14/2	ss15/1	ss15/2	ss15/3	ss15/4	ss15/5	ss16				
cs1	cs2	cs3	cs4	cs5	cs6	cs7	cs8/1	cs8/2	cs8/3	cs9
cs10	cs11	cs12	cs13	cs14	cs15	cs16				

Attachments

404 a b c d

(a)

FREE TEXT:

29 JUN 2011

THE FIREMAN LIMITED
PO BOX 11446
PALM BEACH
PAPAMOA 3151

Rotorua District Council
1061 Haupapa Street
Private Bag 3029
Rotorua Mail Centre
Rotorua 3046
New Zealand
P: 07 348 4199
F: 07 346 3143
E: mail@rdc.govt.nz
W: www.rdc.govt.nz

File Ref: P02494
Building Consents no: 67914

Dear Sir/Madam,

BUILDING CONSENT

Address of Project: 11 SOPHIA STREET

Please find enclosed your Building Consent and its relevant Plans and Specifications.

You should take time to read the Conditions that are attached to your Building Consent and Plans, including the stamps on those plans.

You should also be aware that in some instances although you have received your Building Consent, there may still be outstanding issues regarding land use, etc. You will need to finalise these before you undertake any building work.

However, if you have received your Resource Consent (if required), your Project Information Memorandum and have satisfied all the Conditions set out in those documents, then you are free to start your building work.

Remember, you need to arrange for all the inspections that have been estimated and are listed as Conditions to your Building Consent. You will need to give Council a minimum of 48 hours notice of requiring an inspection. Remember also that you or your agent/builder, etc, needs to also attend and/or be on site for any inspection.

"Please remember also to quote your Building Consent No. 67914 when making any inspection bookings." The direct dial number for inspections is 3495646.

We wish you well with your project and look forward to working alongside you to achieve a satisfactory completion of your project.

Please feel free to phone Council's Building Services should you require further information.

Yours faithfully



D. Holder
Building Services Manager

Rotorua District Council
1061 Haupapa Street
Private Bag 3029
Rotorua Mail Centre
Rotorua 3046
New Zealand
P: 07 348 4199
F: 07 346 3143
E: mail@rdc.govt.nz
W: www.rdc.govt.nz

Building Consent No: 67914

Section 51, Building Act 2004

Issued: 29 Jun 2011

Agent

THE FIREMAN LIMITED
PO BOX 11446
PALM BEACH
PAPAMOA 3151

Owner

VINCENT, JILL ROBYN
11 SOPHIA STREET
GLENHOLME
ROTORUA 3010

The Building

Property ID:	02494
Street Address:	11 SOPHIA STREET
Valuation number:	06512 625 00
Legal Description:	Lot 1 DPS15487

First point of contact for communications with council building consent authority:
RDC Building Services – Direct Dial 349 5646

Building Work

The following building work is authorised by this consent:

Project is for:	INSTALLATION OF KENT LOGFIRE MAX SFH
Intended Use:	SOLID FUEL HEATER
Intended Life:	Indefinite but not less than 0 years

This building consent is issued under section 51 of the Building Act 2004. This building consent does not relieve the owner of the building (or proposed building) of any duty or responsibility under any other Act relating to or affecting the building (or proposed building).

This building consent also does not permit the construction, alteration, demolition, or removal of the building (or proposed building) if that construction, alteration, demolition, or removal would be in breach of any other Act.

This Building Consent Is Subject To The Following Conditions:

Inspections By Building Consent Authority (Phone Building Services 3495646 To Book Inspections)

Inbuilt Solid Fuel Heater - (to be inspected prior to inbuilt solid fuel heater being installed).

Final Inspection when all building work is complete

Important Endorsements

Section 52 Building Act 2004 (Lapse of Building Consent)

A Building Consent lapses and is of no effect if the building work to which it relates does not commence within 12 months of the date of issue unless prior arrangements are made with the Building Consent Authority.

Certification For Installation Of Inbuilt Fires

Certification is required from the installer (where authorised by RDC) that all cracks/gaps have been sealed in accordance with the manufacturer's requirements and that the existing chimney is in good structural condition. Certification must be lodged with the CCC application.

Completion Of Work

At completion of work authorised by this consent the Building Act requires you to apply for a Code of Compliance Certificate as soon as practicable after the Building work is completed.

Compliance Schedule

A Compliance Schedule is not required for the building

During consent processing Council estimates the number and type of inspections required to complete a project.

Should additional inspections be required to confirm compliance with the approved Building Consent/Building Code, Council reserves the right to seek payment for these prior to the issue of Code Compliance Certificate.

Signed for and on behalf of the Council:

Name: Helen Ferguson

Position: Building Services Administration.

Signed: _____

Date: 29 JUN 2011

PIM / APPLICATION No. _____

DATE RECEIVED 24/6/2011

DATE ISSUED _____

FILE No. 02494

Form 2

BC ONLY

67914

Received
24 JUN 2011
Rotorua District Council
Customer CentreAPPLICATION FOR PROJECT INFORMATION
MEMORANDUM AND/OR BUILDING CONSENT

Section 33 or Section 45, Building Act 2004

THE BUILDING

Street address of building:

*[for structures that do not have a street address, state the nearest street intersection and the distance and direction from that intersection]*11 Sophia Street
Glenholme

Legal description of land where building is located:

[state legal description as at the date of application and, if the land is proposed to be subdivided, include details of relevant lot numbers and subdivision consent]

Subdivision Consent (if applicable) _____

Valuation No. 06512-625-00 Lot No. 1DPS 15487 Section _____

Block _____ Survey District _____

Building name: _____

Location of building within site/block number:

[include nearest street access]

Number of levels: _____

[include ground level and any levels belowground]

Level/unit number: _____

*[insert level/unit number if applicable]*Area: _____ m²*[total floor area; indicate area affected by the building work if less than the total area]*

Current, lawfully established, use:

[include number of occupants per level and per use if more than 1]

Year first constructed: _____

[insert year, approximate date is acceptable e.g: c1920s or 1960-1970]

Expected completion date: _____

[insert month year]

OFFICE USE ONLY

Administratively Complete

Cost Category _____

Name CHRISTIAN THOMASDate 24/6/2011Signature [Signature]

VETTED

Complete / Incomplete / Exempt

Name _____

Date _____

Signature _____

THE OWNER

Name of owner:

[include preferred form of address, eg, Mr, Miss, Dr, if an individual]

Jill Vincent

Contact person:

[insert mailing address]

Street address/registered office:

[insert street address/registered office]

11 Sophia Street
Glenholme
Rotorua

Phone numbers:

Landline:

Daytime:

Mobile:

After Hours:

Facsimile number:

Email address:

Website:

[website address if applicable]

The following evidence of ownership attached to this application:

[current copy of Certificate of Title less than 6 months old, lease, agreement for sale and purchase, or other document showing full name of legal owner(s) of building]

AGENT

Name of agent:

[include preferred form of address, eg, Mr, Miss, Dr, if an individual]

The Fireman Ltd

Contact person:

[insert contact name]

Sara Hansen

Mailing Address:

[insert mailing address]

PO Box 11446
Papamoa 3151

Street address/registered office:

[insert street address/registered office]

Phone numbers:

0800 347 362

Landline:

Daytime:

Mobile:

After Hours:

Facsimile number:

Email address:

admin@the-fireman.co.nz

Website:

[website address if applicable]

Relationship to owner:

[state details of the authorisation from the owner to make the application on the owner's behalf]

First point of contact for communications with the council/building consent authority:
[all invoices and refunds related to this application will be directed to this person in all instances]

The Fireman Ltd

APPLICATION

I request that you issue a ~~†[project information memorandum/project information memorandum and building consent/building consent]~~ [delete which is not applicable] for the building work described in this application

If you do not want information contained in this application to be made available for purposes of marketing please tick the box ☒
Signature of [owner/agent on behalf of and with the authority of the owner]

M/M/4/1

Date: 23/06/11

☒ A separate vetting check sheet has been completed and attached by the Applicant. [compulsory]
Available from council or online at council web page.

To be completed in lieu of Authorisation Letter

I, _____ as owner of the above property,
authorise _____ to act as my agent.

Signature _____ Date _____

THE PROJECT

Description of the building work:
[provide sufficient description of building work to enable scope of work to be fully understood]

*Installation of Kent Logfire Max
Solid fuel heater*

Will the building work result in a change of use of the building?

Yes ☐ No ☒ [if in doubt, please check information brochure]

If Yes, provide details of the new use:
[provide description of new use]

List building consents previously issued for this project (if any):
[list who issued the consent, the date of issue and the consent number]

Intended life of the building if less than 50 years: 15

Estimated value of the building work on which the building levy will be calculated (including goods and services tax):

[state estimated value as defined in section 7 of the Building Act 2004]

\$ 3900 =

Number of Toilet Pans: _____
(Commercial properties only)

PROJECT INFORMATION MEMORANDUM

The following matters are involved in the project

- ☐ Subdivision
- ☐ Alterations to land contours
- ☐ New or altered connections to public utilities
- ☐ New or altered access for vehicles
- ☐ Disposal of stormwater and wastewater

- ☐ New or altered locations and/or external dimensions of buildings
- ☐ Building work over or adjacent to any road or public place
- ☐ Building work over any existing drains or sewers or in close proximity to wells or water mains
- ☐ Other matters known to the applicant that may require authorisations from the territorial authority: [specify]

BUILDING CONSENT

The following plans and specifications are attached to this application:

The building work will comply with the building code as follows: *[Delete this section if this is an application for a PIM only]*

Clause <i>[which of the following clauses will be involved in the proposed building work?]</i>	Means of compliance <i>[refer to the relevant compliance document(s) or detail of alternative solution in the plans and specifications]</i>	Proposed inspections <i>[state means of inspection. Note PS4 or certification may be required]</i>
<input checked="" type="checkbox"/> B1 Structure	<input checked="" type="checkbox"/> B1/AS2 <input type="checkbox"/> NZS 3604 <input type="checkbox"/> AS/NZS1170 <input type="checkbox"/> NZS 4229 <input type="checkbox"/> Other _____ <i>[Specify]</i>	<input type="checkbox"/> Council <input type="checkbox"/> Engineer <input type="checkbox"/> Other _____ <i>[Specify]</i>
<input checked="" type="checkbox"/> B2 Durability	<input checked="" type="checkbox"/> B2/AS1 <input type="checkbox"/> NZS 3101 <input type="checkbox"/> NZS 3602 <input type="checkbox"/> NZS 3604 <input type="checkbox"/> Other _____ <i>[Specify]</i>	<input type="checkbox"/> Council <input type="checkbox"/> Engineer <input type="checkbox"/> Other _____ <i>[Specify]</i>
<input type="checkbox"/> C1- 4 Fire	<input type="checkbox"/> C1/AS1 <input type="checkbox"/> Other _____ <i>[Specify]</i>	<input type="checkbox"/> Council <input type="checkbox"/> Engineer <input type="checkbox"/> Other _____ <i>[Specify]</i>
<input type="checkbox"/> D1 Access Routes	<input type="checkbox"/> D1/AS1 <input type="checkbox"/> NZS 4121 <input type="checkbox"/> NZS 4121 <input type="checkbox"/> Other _____ <i>[Specify]</i>	<input type="checkbox"/> Council <input type="checkbox"/> Engineer <input type="checkbox"/> Other _____ <i>[Specify]</i>
<input type="checkbox"/> D2 Mechanical installations for access	<input type="checkbox"/> D2/AS1 <input type="checkbox"/> NZS 4332 <input type="checkbox"/> EN 81 <input type="checkbox"/> EN 115 <input type="checkbox"/> Other _____ <i>[Specify]</i>	<input type="checkbox"/> Engineer <input type="checkbox"/> Other _____ <i>[Specify]</i>
<input type="checkbox"/> E1 Surface Water	<input type="checkbox"/> E1/AS1 <input type="checkbox"/> AS/NZS3500.3 <input type="checkbox"/> Other _____ <i>[Specify]</i>	<input type="checkbox"/> Council <input type="checkbox"/> Other _____ <i>[Specify]</i>
<input checked="" type="checkbox"/> E2 External Moisture	<input checked="" type="checkbox"/> E2/AS1 <input type="checkbox"/> Specific design & testing	<input type="checkbox"/> Council <input type="checkbox"/> Other _____ <i>[Specify]</i>
<input type="checkbox"/> E3 Internal Moisture	<input type="checkbox"/> E3/AS1 <input type="checkbox"/> Other _____ <i>[Specify]</i>	<input type="checkbox"/> Council <input type="checkbox"/> Other _____ <i>[Specify]</i>
<input type="checkbox"/> F1 Hazardous Agents on Site	<input type="checkbox"/> F1/AS1 <input type="checkbox"/> Other _____ <i>[Specify]</i>	<input type="checkbox"/> Council <input type="checkbox"/> Other _____ <i>[Specify]</i>
<input type="checkbox"/> F2 Hazardous Building Materials	<input type="checkbox"/> F2/AS1 <input type="checkbox"/> NZS 4223 <input type="checkbox"/> Other _____ <i>[Specify]</i>	<input type="checkbox"/> Council <input type="checkbox"/> Other _____ <i>[Specify]</i>
<input type="checkbox"/> F3 Hazardous Substances and Processes	<input type="checkbox"/> F3/AS1 <input type="checkbox"/> Other _____ <i>[Specify]</i> <input type="checkbox"/> NZS 3604 <input type="checkbox"/> Other _____ <i>[Specify]</i>	<input type="checkbox"/> Council <input type="checkbox"/> Other _____ <i>[Specify]</i>
<input type="checkbox"/> F4 Safety from Falling	<input type="checkbox"/> F4/AS1 FSP Act <input type="checkbox"/> Other _____ <i>[Specify]</i>	<input type="checkbox"/> Council <input type="checkbox"/> Other _____ <i>[Specify]</i>
<input type="checkbox"/> F5 Construction and Demolition Hazards	<input type="checkbox"/> F5/AS1 <input type="checkbox"/> Other _____ <i>[Specify]</i>	<input type="checkbox"/> Council <input type="checkbox"/> Other _____ <i>[Specify]</i>
<input type="checkbox"/> F6 Lighting for Emergency	<input type="checkbox"/> F6/AS1 <input type="checkbox"/> Other _____ <i>[Specify]</i>	<input type="checkbox"/> Council <input type="checkbox"/> Other _____ <i>[Specify]</i>

The building work will comply with the building code as follows: *[Continued]*

Clause		Means of compliance		Proposed inspections	
<input checked="" type="checkbox"/> F7	Warning Systems	<input checked="" type="checkbox"/> F7/AS1	<input type="checkbox"/> AS/NZS 1668 <input type="checkbox"/> NZS 4512	<input type="checkbox"/> Council	<input type="checkbox"/> Engineer
		<input type="checkbox"/> NZS 4515	<input type="checkbox"/> Other _____ <i>[Specify]</i>	<input type="checkbox"/> Other _____ <i>[Specify]</i>	
<input type="checkbox"/> F8	Signs	<input type="checkbox"/> F8/AS1	<input type="checkbox"/> Other _____ <i>[Specify]</i>	<input type="checkbox"/> Council	
				<input type="checkbox"/> Other _____ <i>[Specify]</i>	
<input type="checkbox"/> G1	Personal Hygiene	<input type="checkbox"/> G1/AS1	<input type="checkbox"/> Other _____ <i>[Specify]</i>	<input type="checkbox"/> Council	
				<input type="checkbox"/> Other _____ <i>[Specify]</i>	
<input type="checkbox"/> G2	Laundering	<input type="checkbox"/> G2/AS1	<input type="checkbox"/> Other _____ <i>[Specify]</i>	<input type="checkbox"/> Council	
				<input type="checkbox"/> Other _____ <i>[Specify]</i>	
<input type="checkbox"/> G3	Food preparation and prevention of contamination	<input type="checkbox"/> G3/AS1	<input type="checkbox"/> Other _____ <i>[Specify]</i>	<input type="checkbox"/> Council	
				<input type="checkbox"/> Other _____ <i>[Specify]</i>	
<input type="checkbox"/> G4	Ventilation	<input type="checkbox"/> G4/AS1	<input type="checkbox"/> AS/NZS 1668.2	<input type="checkbox"/> Council	
			<input type="checkbox"/> Other _____ <i>[Specify]</i>	<input type="checkbox"/> Other _____ <i>[Specify]</i>	
<input type="checkbox"/> G5	Interior environment	<input type="checkbox"/> G5/AS1	<input type="checkbox"/> Other _____ <i>[Specify]</i>	<input type="checkbox"/> Council	
				<input type="checkbox"/> Other _____ <i>[Specify]</i>	
<input type="checkbox"/> G6	Airborne & Impact Sound	<input type="checkbox"/> G6/AS1	<input type="checkbox"/> Other _____ <i>[Specify]</i>	<input type="checkbox"/> Council	
				<input type="checkbox"/> Other _____ <i>[Specify]</i>	
<input type="checkbox"/> G7	Natural Light	<input type="checkbox"/> G7/AS1	<input type="checkbox"/> Other _____ <i>[Specify]</i>	<input type="checkbox"/> Council	
				<input type="checkbox"/> Other _____ <i>[Specify]</i>	
<input type="checkbox"/> G8	Artificial Light	<input type="checkbox"/> G8/AS1	<input type="checkbox"/> NZS 6703	<input type="checkbox"/> Council	
			<input type="checkbox"/> Other _____ <i>[Specify]</i>	<input type="checkbox"/> Other _____ <i>[Specify]</i>	
<input type="checkbox"/> G9	Electricity	<input type="checkbox"/> G9/AS1	<input type="checkbox"/> Other _____ <i>[Specify]</i>	By certification only	
<input type="checkbox"/> G10	Piped Services	<input type="checkbox"/> G10/AS1	<input type="checkbox"/> NZS 5261	By certification only	
			<input type="checkbox"/> Other _____ <i>[Specify]</i>		
<input type="checkbox"/> G11	Gas as an energy source	<input type="checkbox"/> G11/AS1	<input type="checkbox"/> Other _____ <i>[Specify]</i>	By certification only	
<input type="checkbox"/> G12	Water Supplies	<input type="checkbox"/> G12/AS1	<input type="checkbox"/> AS/NZS 3500.1 <input type="checkbox"/> AS/NZS 3500.4	<input type="checkbox"/> Council	
			<input type="checkbox"/> Other _____ <i>[Specify]</i>	<input type="checkbox"/> Other _____ <i>[Specify]</i>	
<input type="checkbox"/> G13	Foul Water	<input type="checkbox"/> G13/AS1	<input type="checkbox"/> AS/NZS 3500.2 BS 5572	<input type="checkbox"/> Council	
			<input type="checkbox"/> Other _____ <i>[Specify]</i>	<input type="checkbox"/> Other _____ <i>[Specify]</i>	
<input type="checkbox"/> G14	Industrial Liquid Waste	<input type="checkbox"/> G14/AS1	<input type="checkbox"/> Other _____ <i>[Specify]</i>	<input type="checkbox"/> Council	
				<input type="checkbox"/> Other _____ <i>[Specify]</i>	
<input type="checkbox"/> G15	Solid Waste	<input type="checkbox"/> G15/AS1	<input type="checkbox"/> Other _____ <i>[Specify]</i>	<input type="checkbox"/> Council	
				<input type="checkbox"/> Other _____ <i>[Specify]</i>	
<input type="checkbox"/> H1	Energy Efficiency	<input type="checkbox"/> H1/AS1	<input type="checkbox"/> NZS 4218 <input type="checkbox"/> NZS 4243	<input type="checkbox"/> Council	
		<input type="checkbox"/> ALF Design Manual		<input type="checkbox"/> Other _____ <i>[Specify]</i>	
		<input type="checkbox"/> NZS 4214	<input type="checkbox"/> Other _____ <i>[Specify]</i>		

WAIVER/MODIFICATION TO NZ BUILDING CODE REQUIRED FOR FOLLOWING PARTS OF CODE:Supporting documentation attached as follows *[please list]***COMPLIANCE SCHEDULE***The specified systems for the building are as follows: [specified systems are defined in regulations]*

Any system installed from below to be accompanied by procedures for inspection and routine maintenance. [Council to vet and verify in first column.]		COUNCIL	Applicant to complete				
			Existing	New	Altered	Added	Removed
There are no specified systems in the building <input type="checkbox"/>							
Specified Systems Prescribed by Building Act 2004 Compliance Schedule Handbook 25 May 2007							
ss1	Automatic systems for fire suppression	<input type="checkbox"/>	<input type="checkbox"/>	<input type="checkbox"/>	<input type="checkbox"/>	<input type="checkbox"/>	<input type="checkbox"/>
ss2	Automatic or manual emergency warning systems for fire or other dangers (other than a warning system for fire that is entirely within a household unit and serves only that unit)	<input type="checkbox"/>	<input type="checkbox"/>	<input type="checkbox"/>	<input type="checkbox"/>	<input type="checkbox"/>	<input type="checkbox"/>
ss3	Electromagnetic or automatic doors and windows						
	ss3/1 Automatic doors	<input type="checkbox"/>	<input type="checkbox"/>	<input type="checkbox"/>	<input type="checkbox"/>	<input type="checkbox"/>	<input type="checkbox"/>
	ss3/2 Access controlled doors	<input type="checkbox"/>	<input type="checkbox"/>	<input type="checkbox"/>	<input type="checkbox"/>	<input type="checkbox"/>	<input type="checkbox"/>
	ss3/3 Interfaced fire or smoke doors or windows	<input type="checkbox"/>	<input type="checkbox"/>	<input type="checkbox"/>	<input type="checkbox"/>	<input type="checkbox"/>	<input type="checkbox"/>
ss4	Emergency lighting systems	<input type="checkbox"/>	<input type="checkbox"/>	<input type="checkbox"/>	<input type="checkbox"/>	<input type="checkbox"/>	<input type="checkbox"/>
ss5	Escape route pressurisation systems	<input type="checkbox"/>	<input type="checkbox"/>	<input type="checkbox"/>	<input type="checkbox"/>	<input type="checkbox"/>	<input type="checkbox"/>
ss6	Riser mains for use by fire services	<input type="checkbox"/>	<input type="checkbox"/>	<input type="checkbox"/>	<input type="checkbox"/>	<input type="checkbox"/>	<input type="checkbox"/>
ss7	Automatic back-flow preventers connected to a potable water supply	<input type="checkbox"/>	<input type="checkbox"/>	<input type="checkbox"/>	<input type="checkbox"/>	<input type="checkbox"/>	<input type="checkbox"/>
ss8	Lifts, escalators, travelators, or other systems for moving people or goods within buildings						
	ss8/1 Passenger carrying lifts	<input type="checkbox"/>	<input type="checkbox"/>	<input type="checkbox"/>	<input type="checkbox"/>	<input type="checkbox"/>	<input type="checkbox"/>
	ss8/2 Services lifts	<input type="checkbox"/>	<input type="checkbox"/>	<input type="checkbox"/>	<input type="checkbox"/>	<input type="checkbox"/>	<input type="checkbox"/>
	ss8/3 Escalators and moving walks	<input type="checkbox"/>	<input type="checkbox"/>	<input type="checkbox"/>	<input type="checkbox"/>	<input type="checkbox"/>	<input type="checkbox"/>
ss9	Mechanical ventilation or air conditioning systems	<input type="checkbox"/>	<input type="checkbox"/>	<input type="checkbox"/>	<input type="checkbox"/>	<input type="checkbox"/>	<input type="checkbox"/>
ss10	Building maintenance units providing access to exterior and interior walls of buildings	<input type="checkbox"/>	<input type="checkbox"/>	<input type="checkbox"/>	<input type="checkbox"/>	<input type="checkbox"/>	<input type="checkbox"/>
ss11	Laboratory fume cupboards	<input type="checkbox"/>	<input type="checkbox"/>	<input type="checkbox"/>	<input type="checkbox"/>	<input type="checkbox"/>	<input type="checkbox"/>
ss12	Audio loops or other assistive listening systems						
	ss12/1 Audio loops	<input type="checkbox"/>	<input type="checkbox"/>	<input type="checkbox"/>	<input type="checkbox"/>	<input type="checkbox"/>	<input type="checkbox"/>
	ss12/2 FM radio frequency systems and infrared beam transmission systems	<input type="checkbox"/>	<input type="checkbox"/>	<input type="checkbox"/>	<input type="checkbox"/>	<input type="checkbox"/>	<input type="checkbox"/>
ss13	Smoke control systems						
	ss13/1 Mechanical smoke control	<input type="checkbox"/>	<input type="checkbox"/>	<input type="checkbox"/>	<input type="checkbox"/>	<input type="checkbox"/>	<input type="checkbox"/>
	ss13/2 Natural smoke control	<input type="checkbox"/>	<input type="checkbox"/>	<input type="checkbox"/>	<input type="checkbox"/>	<input type="checkbox"/>	<input type="checkbox"/>
	ss13/3 Smoke curtains	<input type="checkbox"/>	<input type="checkbox"/>	<input type="checkbox"/>	<input type="checkbox"/>	<input type="checkbox"/>	<input type="checkbox"/>
ss14	Emergency power systems for a system or feature specified in any of specified systems 1–13	<input type="checkbox"/>	<input type="checkbox"/>	<input type="checkbox"/>	<input type="checkbox"/>	<input type="checkbox"/>	<input type="checkbox"/>
	ss14/1 Emergency power systems	<input type="checkbox"/>	<input type="checkbox"/>	<input type="checkbox"/>	<input type="checkbox"/>	<input type="checkbox"/>	<input type="checkbox"/>
	ss14/2 Signs in relation to any specified systems 1–13	<input type="checkbox"/>	<input type="checkbox"/>	<input type="checkbox"/>	<input type="checkbox"/>	<input type="checkbox"/>	<input type="checkbox"/>

COMPLIANCE SCHEDULE [Continued]

		COUNCIL	Existing	New	Altered	Added	Removed
ss15	Other fire safety systems of features						
*	ss15/1 Systems for communicating spoken information intended to facilitate evacuation	<input type="checkbox"/>	<input type="checkbox"/>	<input type="checkbox"/>	<input type="checkbox"/>	<input type="checkbox"/>	<input type="checkbox"/>
*	ss15/2 Final exits	<input type="checkbox"/>	<input type="checkbox"/>	<input type="checkbox"/>	<input type="checkbox"/>	<input type="checkbox"/>	<input type="checkbox"/>
*	ss15/3 Fire separations	<input type="checkbox"/>	<input type="checkbox"/>	<input type="checkbox"/>	<input type="checkbox"/>	<input type="checkbox"/>	<input type="checkbox"/>
*	ss15/4 Signs for communicating information	<input type="checkbox"/>	<input type="checkbox"/>	<input type="checkbox"/>	<input type="checkbox"/>	<input type="checkbox"/>	<input type="checkbox"/>
*	ss15/5 Smoke separations.	<input type="checkbox"/>	<input type="checkbox"/>	<input type="checkbox"/>	<input type="checkbox"/>	<input type="checkbox"/>	<input type="checkbox"/>
ss16	Cable cars	<input type="checkbox"/>	<input type="checkbox"/>	<input type="checkbox"/>	<input type="checkbox"/>	<input type="checkbox"/>	<input type="checkbox"/>

* Only include where one or more of ss1 - 6, 9 or 13 are included.

ATTACHMENTS

The following documents are attached to this application:

☐ Certificate attached to project information memorandum

☒ Plans and specifications [list] Floor plans, Fire specs, Flashing Details

☐ Project information memorandum

☐ Development contribution notice.

BUILDING PRACTITIONERS**Builder:**

Business/name: _____

Address: _____

Phone: _____ Mobile: _____ After hours: _____ Facsimile: _____

Email: _____ Registration/qualification: _____

Designer/Architect:

Business/name: _____

Address: _____

Phone: _____ Mobile: _____ After hours: _____ Facsimile: _____

Email: _____ Registration/qualification: _____

Structural Engineer:

Business/name: _____

Address: _____

Phone: _____ Mobile: _____ After hours: _____ Facsimile: _____

Email: _____ Registration/qualification: _____

Engineer (identify practice college):

Business/name: _____

Address: _____

Phone: _____ Mobile: _____ After hours: _____ Facsimile: _____

Email: _____ Registration/qualification: _____

BUILDING PRACTITIONERS**Head Contractor/Site Manager/Site Lead**

Business/name: _____

Address: _____

Phone: _____ Mobile: _____ After hours: _____ Facsimile: _____

Email: _____ Registration/qualification: _____

Plumber/Gas Fitter:

Business/name: _____

Address: _____

Phone: _____ Mobile: _____ After hours: _____ Facsimile: _____

Email: _____ Registration/qualification: _____

Drainlayer:

Business/name: _____

Address: _____

Phone: _____ Mobile: _____ After hours: _____ Facsimile: _____

Email: _____ Registration/qualification: _____

Electrician:

Business/name: _____

Address: _____

Phone: _____ Mobile: _____ After hours: _____ Facsimile: _____

Email: _____ Registration/qualification: _____

Other:Business/name: The Fireman LtdAddress: PO Box 11446, Papamoa 3151Phone: 0800 347362 Mobile: _____ After hours: _____ Facsimile: _____Email: admin@thefireman.co.nz Registration/qualification: _____**Other:**

Business/name: _____

Address: _____

Phone: _____ Mobile: _____ After hours: _____ Facsimile: _____

Email: _____ Registration/qualification: _____

Other:

Business/name: _____

Address: _____

Phone: _____ Mobile: _____ After hours: _____ Facsimile: _____

Email: _____ Registration/qualification: _____

Other:

Business/name: _____

Address: _____

Phone: _____ Mobile: _____ After hours: _____ Facsimile: _____

Email: _____ Registration/qualification: _____

COUNCIL USE ONLY**ESTIMATED TOTAL VALUE OF WORK**

\$ 3900.00 GST inclusive Project floor area m²

FEE PAYABLE**Consent deposit**Project Information Memorandum \$ Building Administration \$ 130.00Technical Processing \$ 97.50Industry Levy (DBH) \$ Industry Levy (BRANZ) \$ Developmental Contribution \$ inspect report \$ 77.50\$ Certificate of Title \$ 15.00Producer Statements \$ Compliance Schedules \$ Rural Number \$ Vehicle Crossing \$ Street Damage \$ Water Connection \$ Sewer Connection \$ Other(s) \$ **Total consent deposit** \$ Inspections \$ Processing Peer Review N Z F S **Total balance payable** \$ ~~320.00~~Lodgement deposit \$ 320 -Date paid 24/6/11Receipt No. 2011 348863Consent fee balance \$ Date paid Receipt No. **BC ONLY**# **67914**Granted by A HoffmanSignature [Signature]Date 28/6/11Issued by H FergusonSignature [Signature]Date 29/6/11

Please complete

Forward any refunds or further invoices to:



COMPUTER FREEHOLD REGISTER UNDER LAND TRANSFER ACT 1952

Search Copy



R. W. Muir
Registrar-General
of Land

Identifier SA13C/1179
Land Registration District South Auckland
Date Issued 03 December 1971

Prior References

SA1097/19

Estate	Fee Simple
Area	946 square metres more or less
Legal Description	Lot 1 Deposited Plan South Auckland 15487

Proprietors

Jill Robyn Sutherland

Interests

Appurtenant hereto is a right of way specified in Easement Certificate S541657
Subject to a right of way over part coloured blue on DPS 15487 specified in Easement Certificate S541657
Subject to Section 15 Rotorua Town Lands Act 1920
Subject to Section 8 Coal Mines Amendment Act 1950
H181565 Certificate by the Rotorua City Council relating to a private drain passing through and serving the above described land - 31.5.1978 at 2.56 pm
Subject to a right of way over part marked A on DPS 61824 created by Transfer B062614.2 - 22.1.1992 at 10.45 am
6623240.3 Mortgage to ANZ National Bank Limited - 26.10.2005 at 9:00 am



Identifier

SA13C/1179

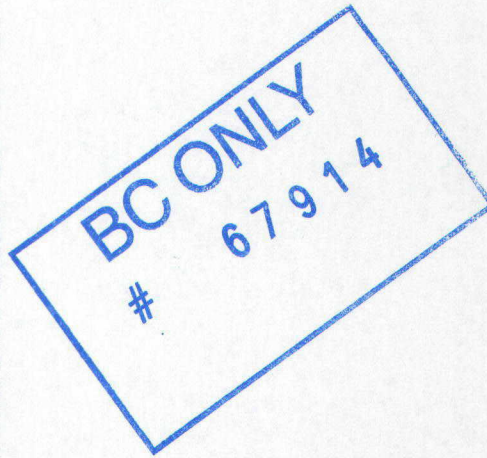
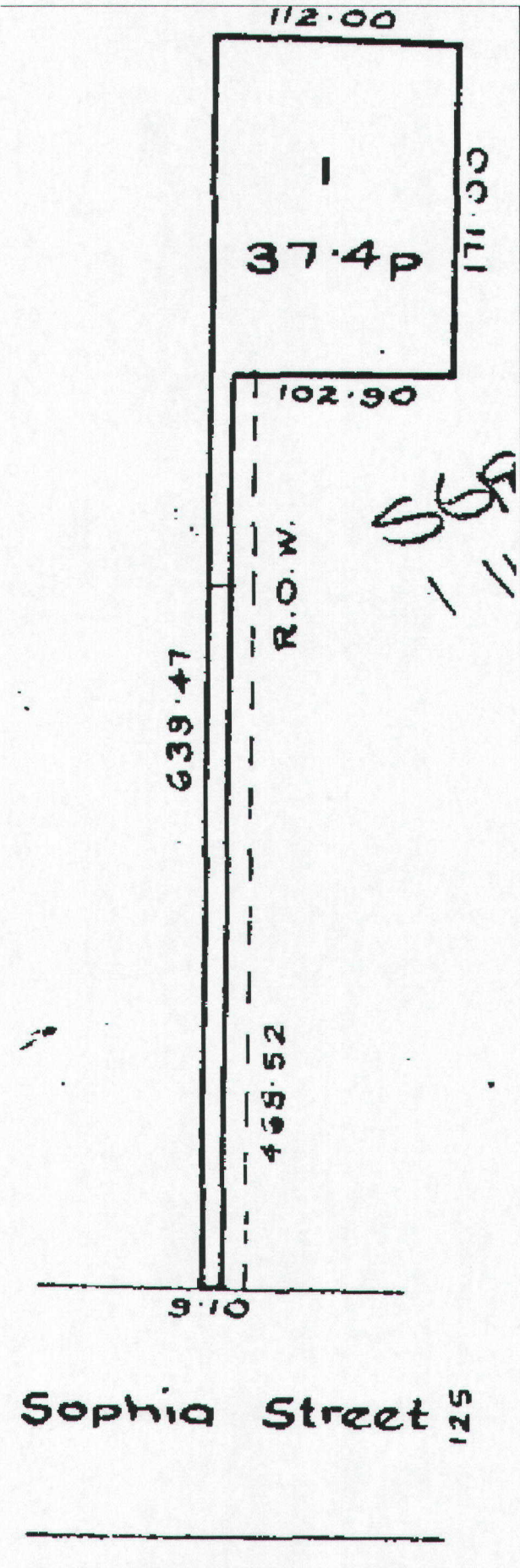



Solid Fuel Burner Processing and Vetting Checklist

For initial completion by the applicant

Ref: CPV 03

Ver: 3

Issued: 16 May 2011

Page 1 of 2

Doc No.: OW-105214

Copies Rqd	ADMINISTRATION CHECKLIST <i>To be completed by Customer Service Centre</i>	Complete
2	Geyserview printout (contour plan) checked with Applicant for Correctness	✓
1	Green PIM/BC Master cover has been completed	✓
1	Site Inspection Card completed	✓
1	Applicant Inspection card complete	✓
1	Form 6 (Application for Code Compliance Certificate) attached to Applicant Inspection Card	✓
	Form 2 administratively complete and front cover signed appropriately	✓

Applicant

S = Supplied

N/A = Not Applicable

Please arrange an vetting appointment through customer services should you wish to lodge this application in person (2 copies of plans and any relevant specifications to be supplied with application)

Building Consent No.

Processor Name:

A Hoffman

Description		Applicant		RDC ONLY		
Solid Fuel Heater C1,C2,B1,E2,E3,B1,B2,F7						
1	Is the appliance 'clean air' approved? Ref: Ministry for the Environment web site for a list of approved appliances (not applicable if over 2 ha) <i>on web page</i>	S	N/A	P	F	N/A
2	Entire floor plan showing distances to windows/doors and flammable materials (Line drawings to show all windows and doors! curtains are restrained if close to fire) <i>line drawings supplied</i>	S	N/A	P	F	N/A
3	Means of Escape not been effected by installation of SFH <i>no change to original</i>	S	N/A	P	F	N/A
4	Hearth dimensions and fixings (Manufacturer's technical literature provided with application) <i>all specifications provided</i>	S	N/A	P	F	N/A
5	Manufacturer specifications provided? (Ensure specific make and model of appliance to be installed is nominated in manufacturer's specifications.).	S	N/A	P	F	N/A
6	Is heat transfer mitigated? (Clearance distances specific to make and mode of appliance are stated in manufacturer's specifications) <i>distances detailed</i>	S	N/A	P	F	N/A
7	Ventilation provided? (opening windows to room) <i>exist building (section)</i>	S	N/A	P	F	N/A
8	Seismic restraint (Refer to manufacturer's specifications) <i>provided</i>	S	N/A	P	F	N/A
9	Domestic smoke alarm(s) detailed on floor plan (Refer to NZBC F7 for requirements within 3m of sleeping areas and on escape route of each level) <i>on plan</i>	S	N/A	P	F	N/A
10	Construction of hearth details Acceptable solution or manufacturer's tested hearth	S	N/A	P	F	N/A
11	Flashing details? Roof/wall penetrations. NZBC E2 or EPDM (alternative solution accepted by Council due to product history) <i>on cross section</i>	S	N/A	P	F	N/A
12	Flue heights above roof	S	N/A	P	F	N/A
13	Cross section through roof provided?	S	N/A	P	F	N/A
Wet back addition G12,H1						
14	Can the appliance be fitted with a wet back? Ref: Ministry for the Environment web site for a list of approved appliances (not applicable if over 2 ha) <i>not to be installed</i>	S	N/A	P	F	N/A
15	Producer statement/certificate required after installation? Note on building consent (e.g. radiators, pumps etc) <i>h</i>	S	N/A	P	F	N/A

OW-105214

1 of 2

16	Tempering valve for new wet backs?	S	N/A	P	F	N/A
17	Wetback installation diagram (<i>Fully vented system? Under/Over piping needs to be independently vented</i>)	S	N/A	P	F	N/A
Other Solid Fuel Heaters, Central Heating etc B1,B2,C1,G4,G12						
19	Second hand fires must have a producer statement from a recognised expert	S	N/A	P	F	N/A
20	Diesel burners have isolating tap? (<i>Do they require automatic cut off solenoid?</i>)	S	N/A	P	F	N/A
21	Exterior diesel burners clear of opening windows/doors? (<i>See instructions for clearance or refer to NZS 5621</i>)	S	N/A	P	F	N/A
22	Piping layout included on plan (<i>radiators</i>)	S	N/A	P	F	N/A
23	Producer statement/certificate required after installation? <i>Note on building consent (e.g. radiators, pumps etc)</i>	S	N/A	P	F	N/A
24	Open fire complies with C/AS1 parts 9–9.5	S	N/A	P	F	N/A

RDC

P = Pass

F = Non-compliance with the Building Code – further information required

N/A = Not Applicable

RDC staff to record reasons for decisions in question text box

Other considerations (*waivers and modifications- alternative solutions, TL and PS format, authors-warnings and bans etc*)

- ☒ Alternative solutions peer reviewed and approved
- ☒ Checklists have BC Number and Processor recorded
- ☒ PIM/ BC/ Amendment Master endorsements completed
- ☒ Category recorded on job card
- ☒ Approved plans are clearly identifiable
- ☒ Number of inspection recorded on job card

Tick each box where applicable – where one of the above items does not relate to this BC put a cross in the appropriate box

By signing this I am satisfied on reasonable grounds that compliance with the Building Code is established if building work is constructed according to the approved documents that accompany this application. All RFI requests have been addressed and the reasons for these have been recorded on the RFI letter in each instance. I recommend building consent be granted on receipt of the appropriate fees and levies.

Name: A Hoffman Signature: [Signature] Date: 28/6/11

Karen Crisp**From:** Deana Adam [admin@thefireman.co.nz]**Sent:** Monday, 27 June 2011 2:02 p.m.**To:** Karen Crisp**Subject:** RE: BC67898 P07922 38 Harold Cres

Hi Karen

There is not supposed to be a wetback on this fire – I have a new girl doing the applications and she must have ticked the wrong box in error.

Any questions, please let us know.

Cheers

Deana

From: Karen Crisp [mailto:Karen.Crisp@rdc.govt.nz]**Sent:** Monday, 27 June 2011 1:39 p.m.**To:** Deana Adam**Subject:** BC67898 P07922 38 Harold Cres

Deana, letter attached from Allan Hoffman, please reply direct to him. Original letter will be posted also.

Regards

Karen Crisp

Building Services Administrator

Rotorua District Council

Ph 07 349 5646 DDI

Fax 07 349 0993

<<SKMBT_C353 11062713380.pdf>>

**Rotorua**

Officially New Zealand's

Best City...again in 2010

1999

2000

2002

2006

2009

NOTE: - This message may contain privileged and confidential information. If you are not the intended recipient, please do not copy, use or disclose it to anyone and notify us immediately by return email before deleting this email message.



Rotorua District Council Services Plan

Generated on: 24/06/2011 12:06:44 p.m.

Rating Parcel

06512*625*00*

Certificate of Title:

SA13C/1179

Legal Parcel

7125/22 - LOT 1 DPS 15487 - P02494
11 SOPHIA STREET

BC ONLY
67914



Caution: This plan is for the purpose of indicating RDC assets of water, sewerage and stormwater services only. It is not to be used as a site plan for building purposes.

All services are indicated in good faith, however additional services may have been installed that do not appear on this plan.

Position measurements are subject to reasonable tolerances and depth of cover may have changed after installation. Service locations were not recorded relative to one another and display is indicative only. Verify locations prior to excavating with machinery. A Road Opening Notice is required for excavation work within the road reserve.

All valves, hydrants and manholes must be kept clear and accessible at all times. Failure to do so may affect Council or Fire Service response for maintenance or emergency purposes.

Warning: Check for other underground services.

Refer to disclaimer in the LIM document for further data limitations.

Scale: 1:1000

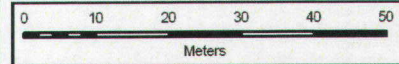

By Post
[Signature]

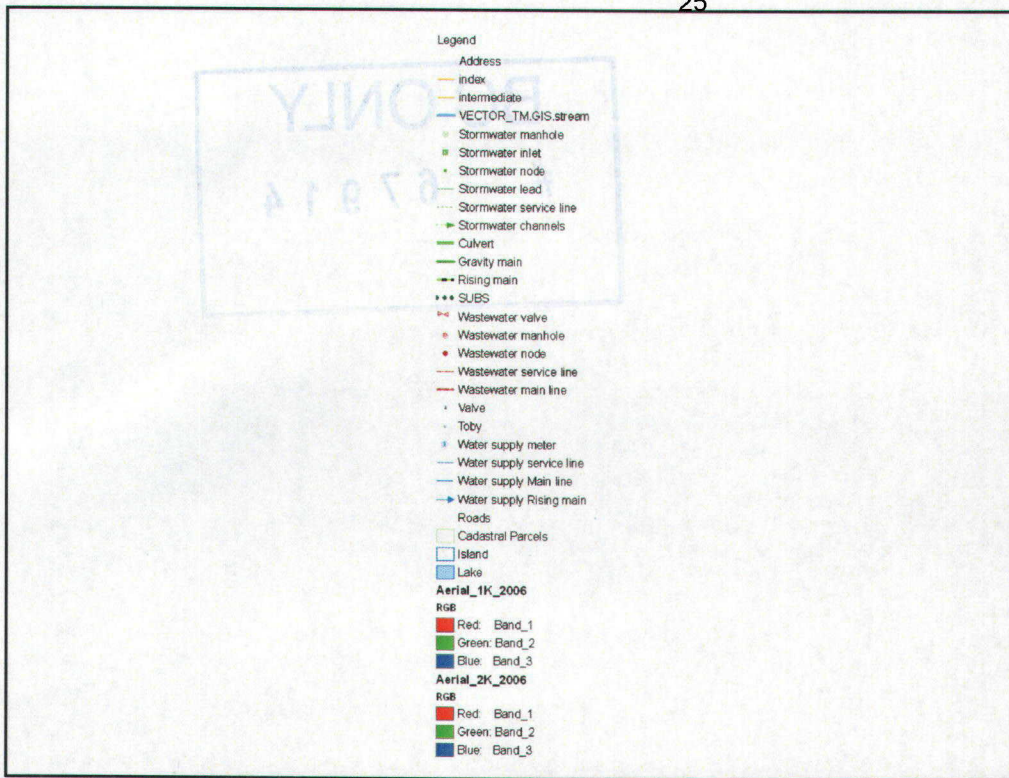



17 June 2011

Ms J Vincent
 11 Sophia Street
 Glenholme
 Rotorua 3010

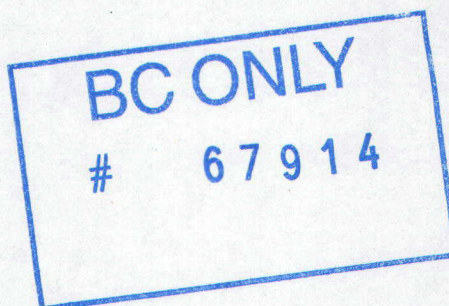

Telephone: 0800 884 880
Facsimile: 0800 884 882
Email: info@boprc.govt.nz
Website: www.boprc.govt.nz
Pollution Hotline: 0800 884 883
International: +64 7 922 3390

Dear Ms Vincent

CONFIRMATION CLEAN HEAT INSTALLATION CAN PROCEED

I am pleased to advise that The Fireman Ltd have confirmed their availability to supply and install your new clean heating device, under the terms of your Installation Service Agreement.

Your Service Provider will now take all necessary steps to supply and install your new heating device at 11 Sophia Street, Rotorua. Pellet and wood burners require a Building Permit and your Service Provider will lodge this on your behalf. It can take three weeks for Rotorua District Council to approve Building Permits. This is outside the control of your Service Provider. Flued gas heaters and heat pump installations are exempt from Building Permits, but have their own specific certification.

Your Service Provider will contact you shortly to arrange access to your property to carry out the installation. If you have any questions regarding the installation of the heating device, please contact your Service Provider directly.

To maintain a high standard of installation, audits are carried out by the Council's Auditor, Eddie Tarrant, who may contact you (or your tenant) to inspect the Service Provider's installation. As your feedback is also important to us, we have enclosed a 'Homeowner Checklist' for you to complete and return in the Freepost envelope provided.

Yours sincerely

Andy Dixon
Asset Accountant

cc: The Fireman Ltd